

# CR-TEC Engineering

Automated Valve Solutions

## CRSF150R

### 3-Way Flanged Ball Valve

- Investment Cast Body and Cap
- Full bore, 'L' and 'T' Type
- Flanged Ends: ANSI B16.5
- Mounting Pad: ISO5211
- Pressure Rating: 150 LB
- Working Temperature: - 25°C + 180°C
- Material: CF8M, CF8, CF3M, WCB



(2-1/2"~4")

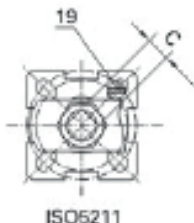
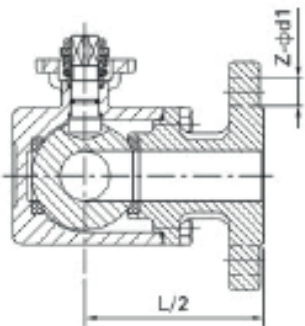

#### PRESSURE-TEMPERATE RATING

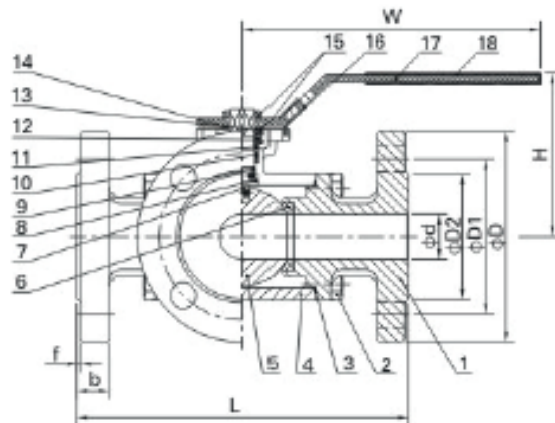
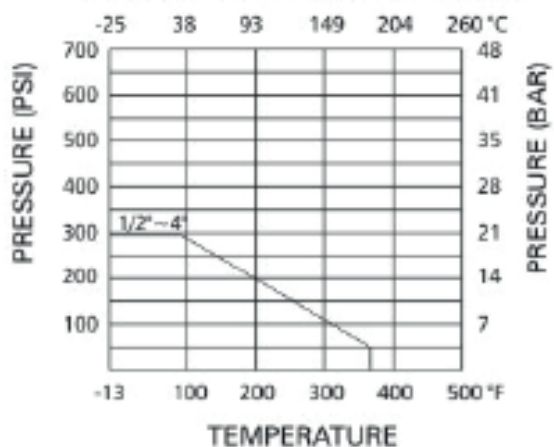

PORT	TURN	0°	90°	180°	270°
T-BALL					
L-BALL					

#### MATERIAL LIST

ITEM	PARTS	MATERIAL	QTY.
1	Cap	CF8M	3
2	Bolt	SS304	12
3	Body Gasket	PTFE	3
4	Body	CF8M	1
5	Ball	SS316	1
6	Ball Seat	R-PTFE(15%)	4
7	Stem	SS316	1
8	Thrust Washer	PTFE	1
9	O-Ring	VITON	1
10	Stem Packing	PTFE	1
11	Stem Ring	SS316	1
12	Belleville Washer	SS301	2
13	Nut Stopper	SS304	1
14	Plate Washer	SS304	1
15	Nut	SS304	2
16	Lock Device	SS304	1
17	Handle	SS304	1
18	Plastic Cover	PLASTIC	1
19	Stop Pin	SS304	1

#### DIMENSION LIST

SIZE	d	L	D	D1	D2	b	f	H	W	C	ISO5211	Z-φd1
1/2"	15	152	89	60.5	35	11	2	77	130	9	F03/F04	4-φ15
3/4"	20	167	98	70	43	11	2	84	161	11	F04/F05	4-φ15
1"	25	180	108	79.5	51	12	2	93	163	11	F04/F05	4-φ15
1-1/4"	32	190	117	89	64	13	2	113	209	14	F05/F07	4-φ15
1-1/2"	40	212	127	98.5	73	15	2	121	209	14	F05/F07	4-φ15
2"	49	230	152	120.5	92	16	2	126	209	14	F05/F07	4-φ19
2-1/2"	62	290	178	139.5	105	18	2	175	450	17	F07/F10	4-φ19
3"	75	310	190	152.5	127	19	2	188	500	17	F07/F10	8-φ19
4"	99	350	229	190.5	157	24	2	211	550	17	F07/F10	8-φ19